

SOUTH MAIN PROFILE
VERT SCALE: 1"=5'

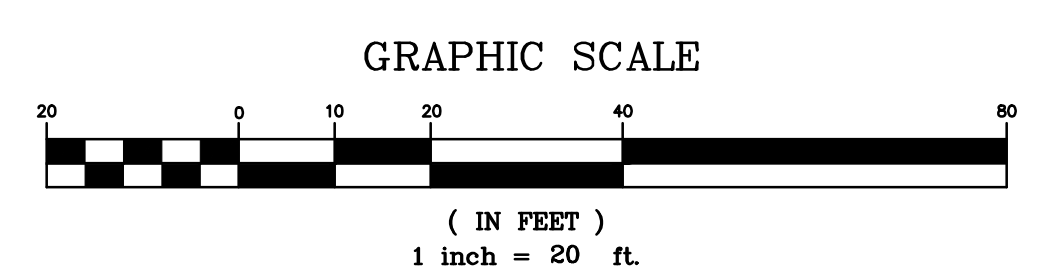

MATCHLINE - STA 33+80 - SEE SHEET C2.5

MATCHLINE - STA 40+00 - SEE SHEET C2.7

MATCHLINE - STA 33+80 - SEE SHEET C2.5

MATCHLINE - STA 40+00 - SEE SHEET C2.7

REVISIONS:

NO.	DATE	DESCRIPTION
1	6/6/22	ISSUED FOR BIDDING

Level II Certification No. 935
Expiration Date: 10-01-23



1050 PARKSIDE COMMONS
SUITE 100
GREENSBORO, GA 30642
TEL: (706) 454-0870
309 N. MAIN ST.
P.O. BOX 309
HINESVILLE, GA 31313
912-244-7900
www.simontonengineering.com

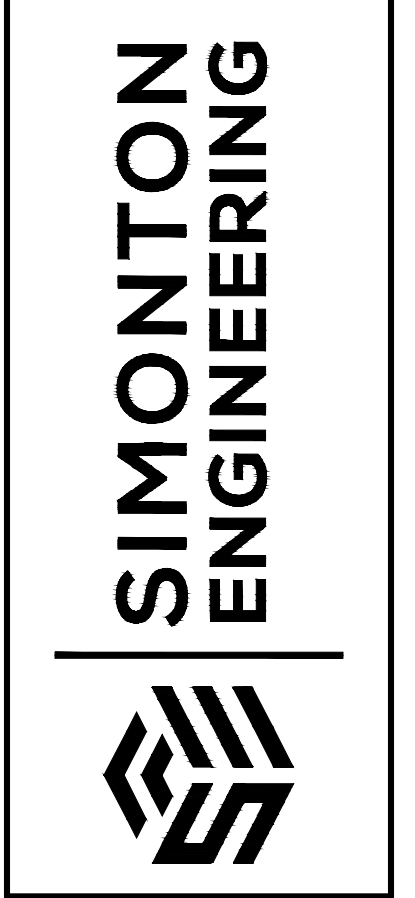

South Main Street Widening
for
The City of Hinesville
Liberty County, Georgia

Plan & Profile
DATE: August 17, 2020
FILE NO: 2010-45PRJ
SHEET: C2.6

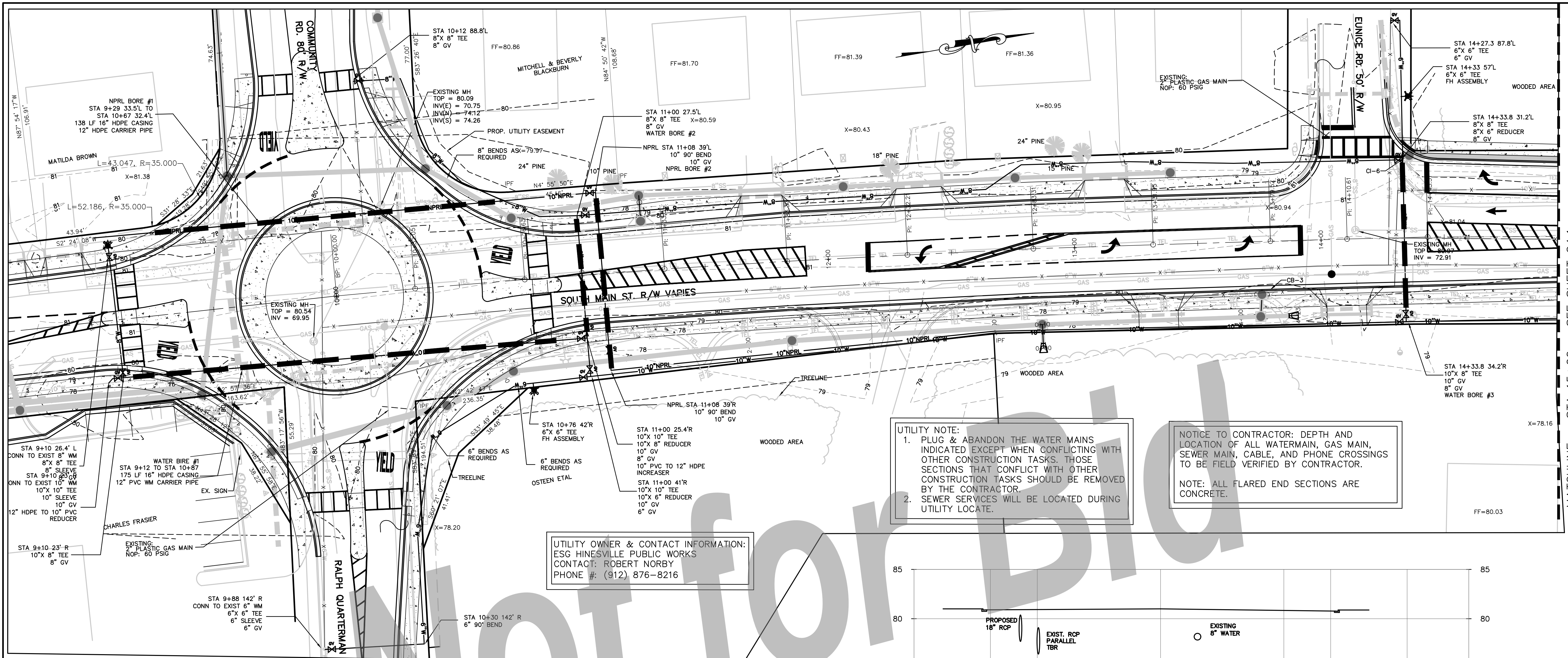

UTILITY OWNER & CONTACT INFORMATION:
 ESG HINESVILLE PUBLIC WORKS
 CONTACT: ROBERT NORBY
 PHONE #: (912) 876-8216

UTILITY NOTE:
 1. PLUG & ABANDON THE WATER MAINS INDICATED EXCEPT WHEN CONFLICTING WITH OTHER CONSTRUCTION TASKS. THOSE SECTIONS THAT CONFLICT WITH OTHER CONSTRUCTION TASKS SHOULD BE REMOVED BY THE CONTRACTOR.
 2. SEWER SERVICES WILL BE LOCATED DURING UTILITY LOCATE.

NOTICE TO CONTRACTOR: DEPTH AND LOCATION OF ALL WATERMAIN, GAS MAIN, SEWER MAIN, CABLE, AND PHONE CROSSINGS TO BE FIELD VERIFIED BY CONTRACTOR.
 NOTE: ALL FLARED END SECTIONS ARE CONCRETE.

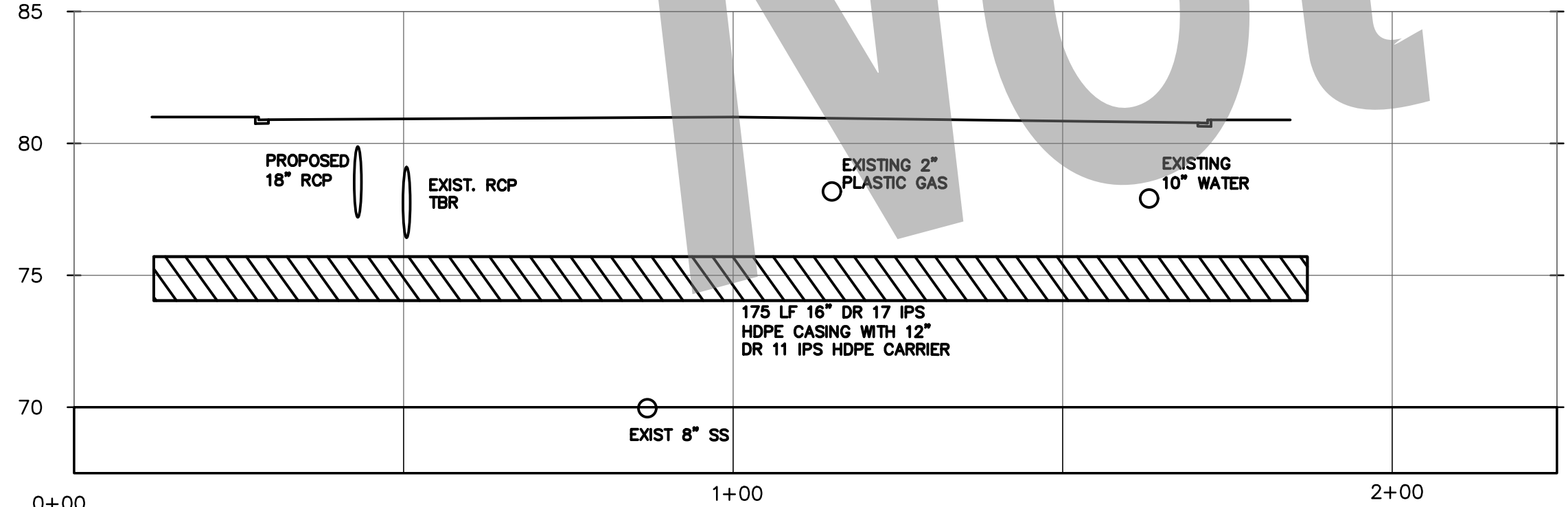

S. Main Water Main Bore #1 PROFILE
 VERT. SCALE: 5

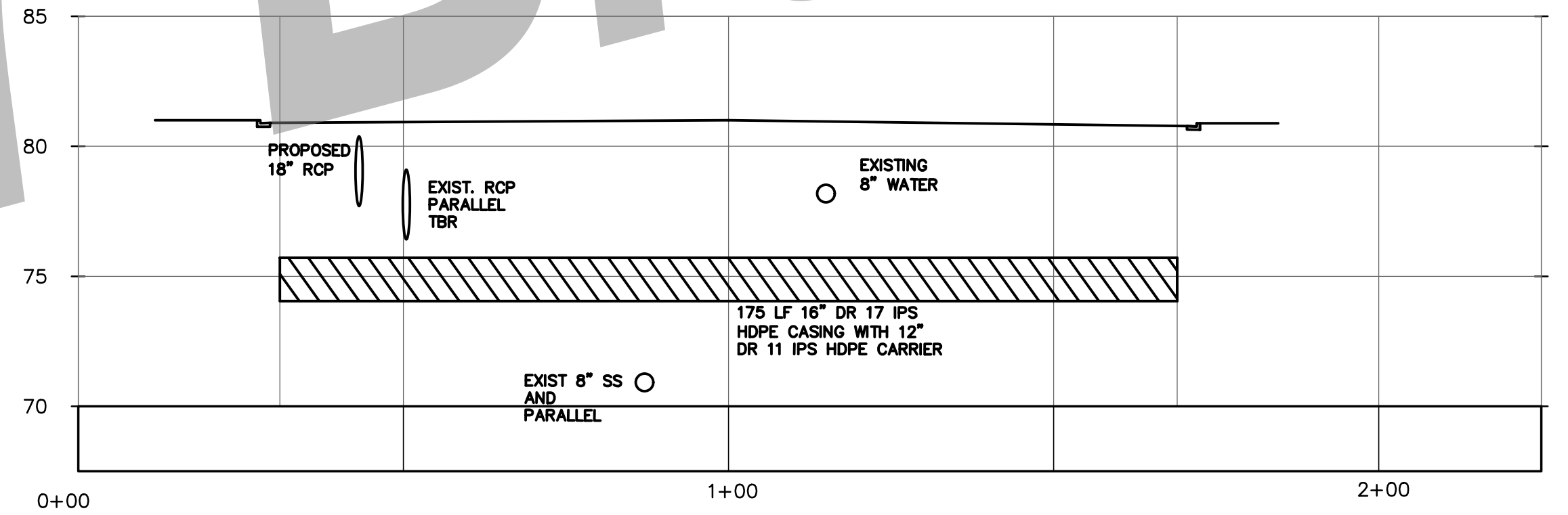

S. Main NPRL Main Bore #1 PROFILE
 VERT. SCALE: 5

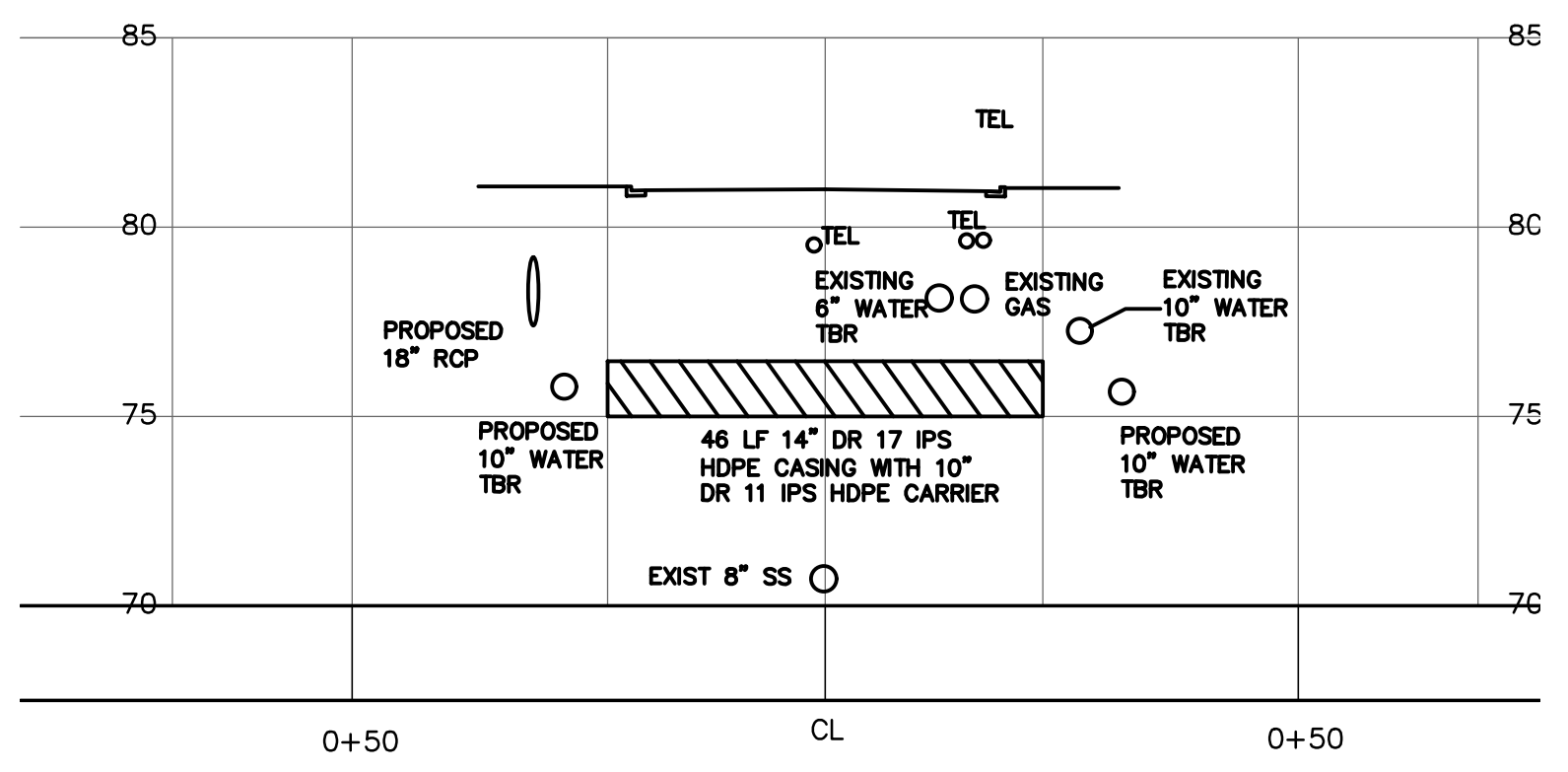

S. Main Water Main Bore #2 PROFILE
 VERT. SCALE: 5

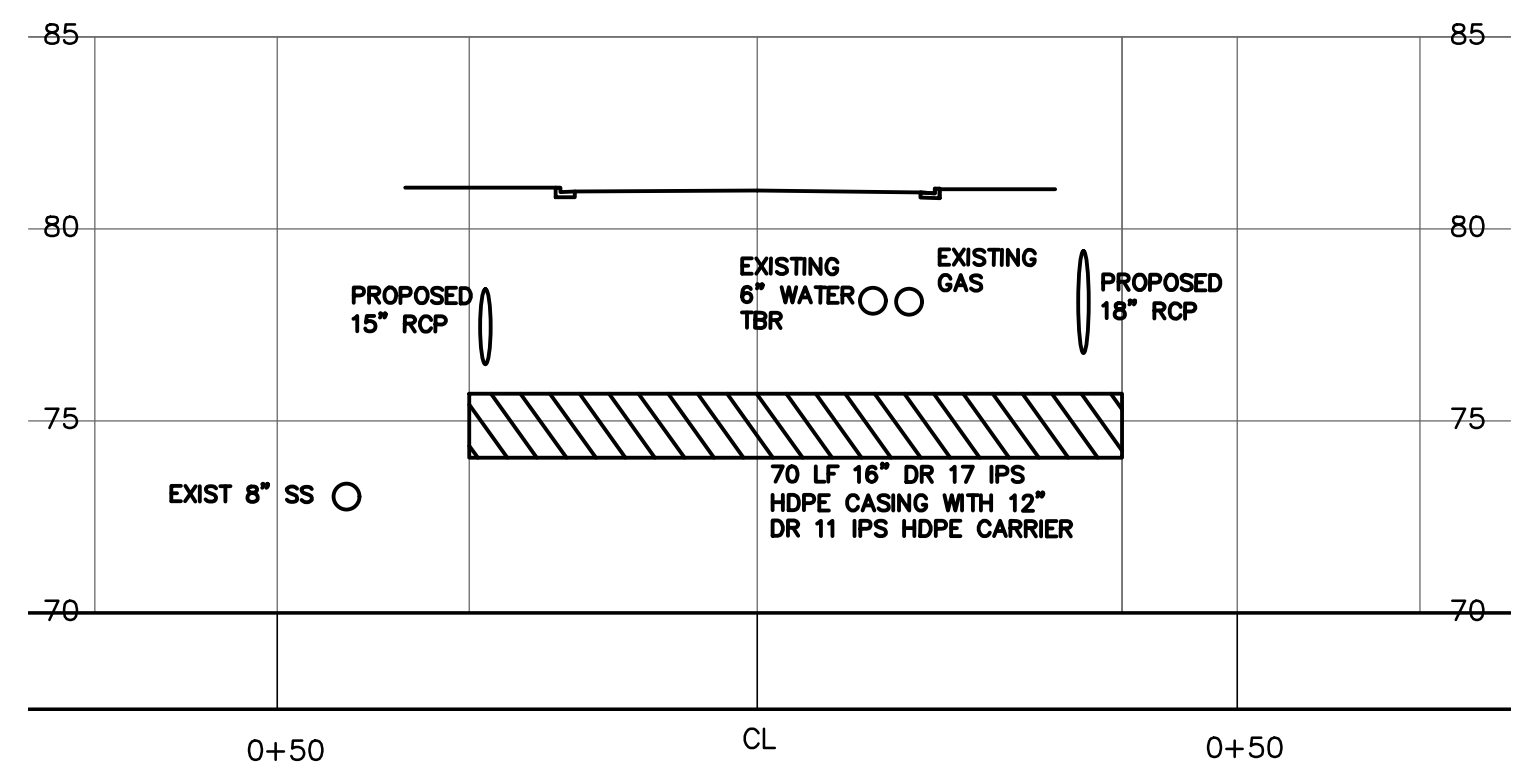

S. Main NPRL Main Bore #2 PROFILE
 VERT. SCALE: 5

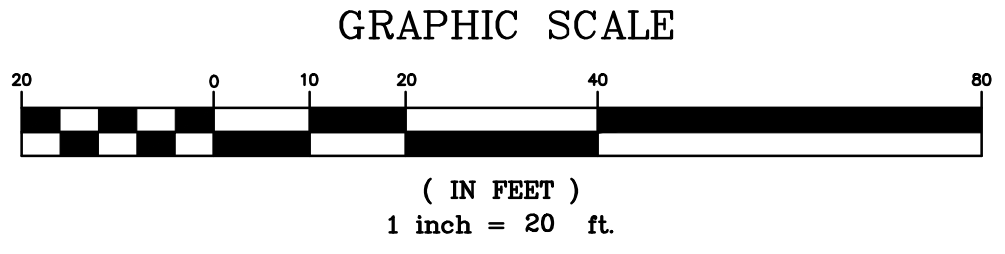

DRAWING COMPLETED BY: STA 15+00 - SEE SHEET C4.1

REVISIONS:
 THIS DRAWING IS AN INSTRUMENT OF SERVICE AND REMAINS THE PROPERTY OF SIMONTON ENGINEERING, LLC. IT MAY NOT BE COPIED, ALTERED, OR REPRODUCED IN ANY MANNER WITHOUT THE WRITTEN CONSENT OF SIMONTON ENGINEERING, LLC. THE EVENT OF AN ELECTRONIC VERSION SIMONTON ENGINEERING, LLC ASSUMES NO LIABILITY FOR THE ACCURACY OF THE INFORMATION CONTAINED HEREIN FOR THE NAMED CLIENT ONLY. IN THE EVENT OF AN ELECTRONIC VERSION, HARD COPIES WILL TAKE PRECEDENCE OVER ANY ELECTRONIC MEDIA. SIMONTON ENGINEERING, LLC.



Level II Certification No. 935
 Expiration Date: 10-01-23
 1050 PARKSIDE COMMONS
 SUITE 101
 GREENSBORO, GA 30642
 TEL: (706) 454-0970
 309 N. MAIN ST.
 P.O. BOX 509
 HINESVILLE, GA 31313
 912-244-7800
 www.simontongenr.com

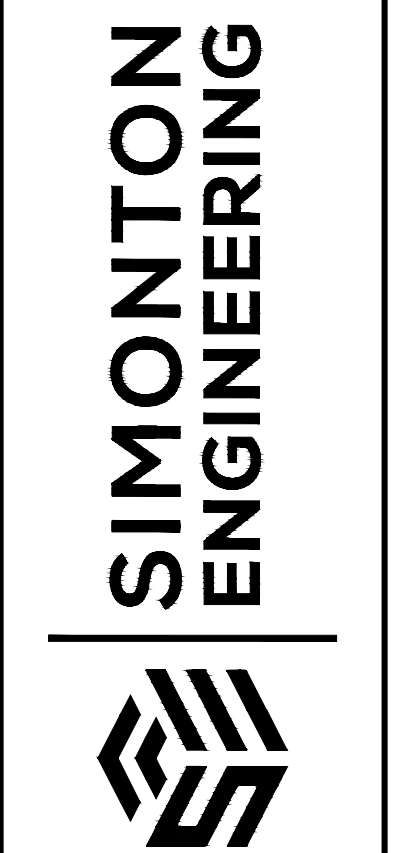

South Main Street Widening
 for
 The City of Hinesville
 Liberty County, Georgia

Utility Plan
 DATE: August 17, 2020
 FILE NO: 2010-45PRJ
 SHEET: C4.0

MATCHLINE - STA 15+00 - SEE SHEET C4.0

MATCHLINE - STA 21+00 - SEE ABOVE

MATCHLINE - STA 21+00 - SEE BELOW

MATCHLINE - STA 27+00 - SEE SHEET C4.2

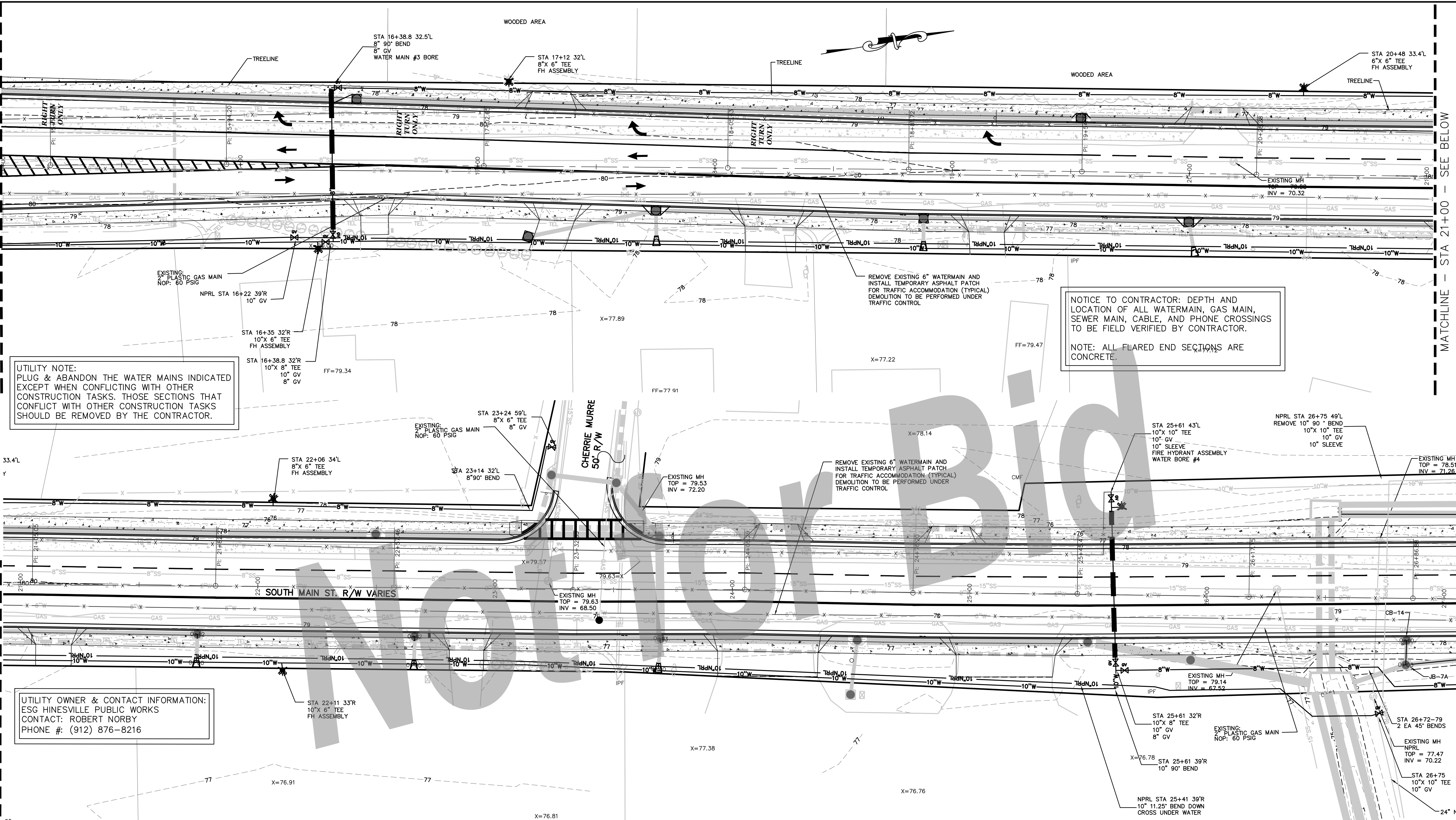

UTILITY NOTE:
 PLUG & ABANDON THE WATER MAINS INDICATED EXCEPT WHEN CONFLICTING WITH OTHER CONSTRUCTION TASKS. THOSE SECTIONS THAT CONFLICT WITH OTHER CONSTRUCTION TASKS SHOULD BE REMOVED BY THE CONTRACTOR.

NOTICE TO CONTRACTOR: DEPTH AND LOCATION OF ALL WATERMAIN, GAS MAIN, SEWER MAIN, CABLE, AND PHONE CROSSINGS TO BE FIELD VERIFIED BY CONTRACTOR.

NOTE: ALL FLARED END SECTIONS ARE CONCRETE.

UTILITY OWNER & CONTACT INFORMATION:
 ESG HINESVILLE PUBLIC WORKS
 CONTACT: ROBERT NORBY
 PHONE #: (912) 876-8216

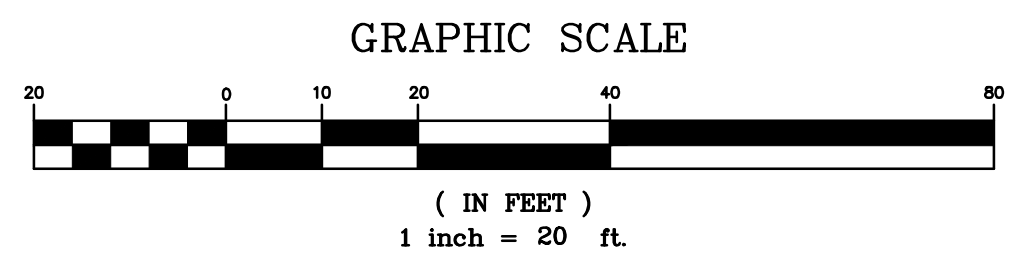
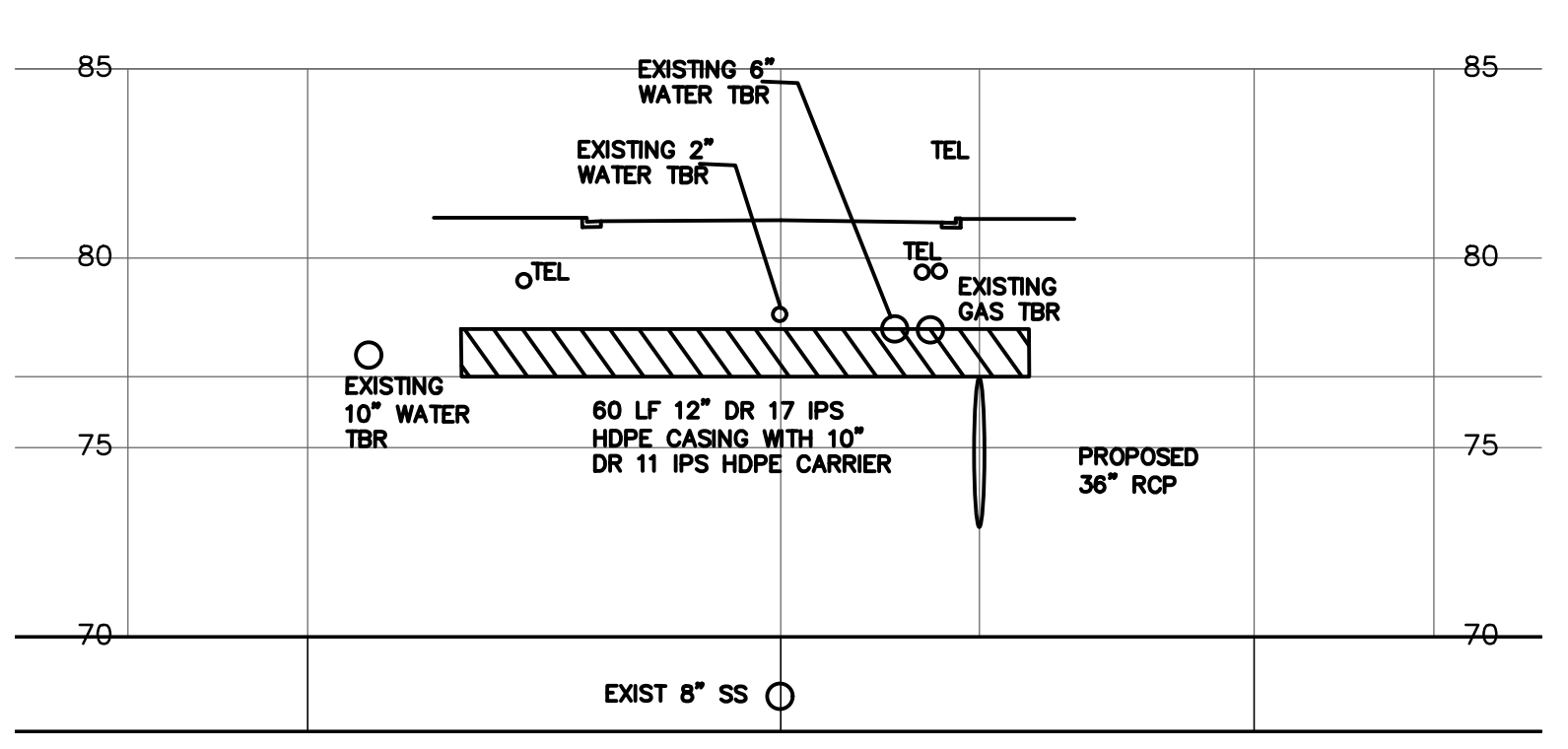
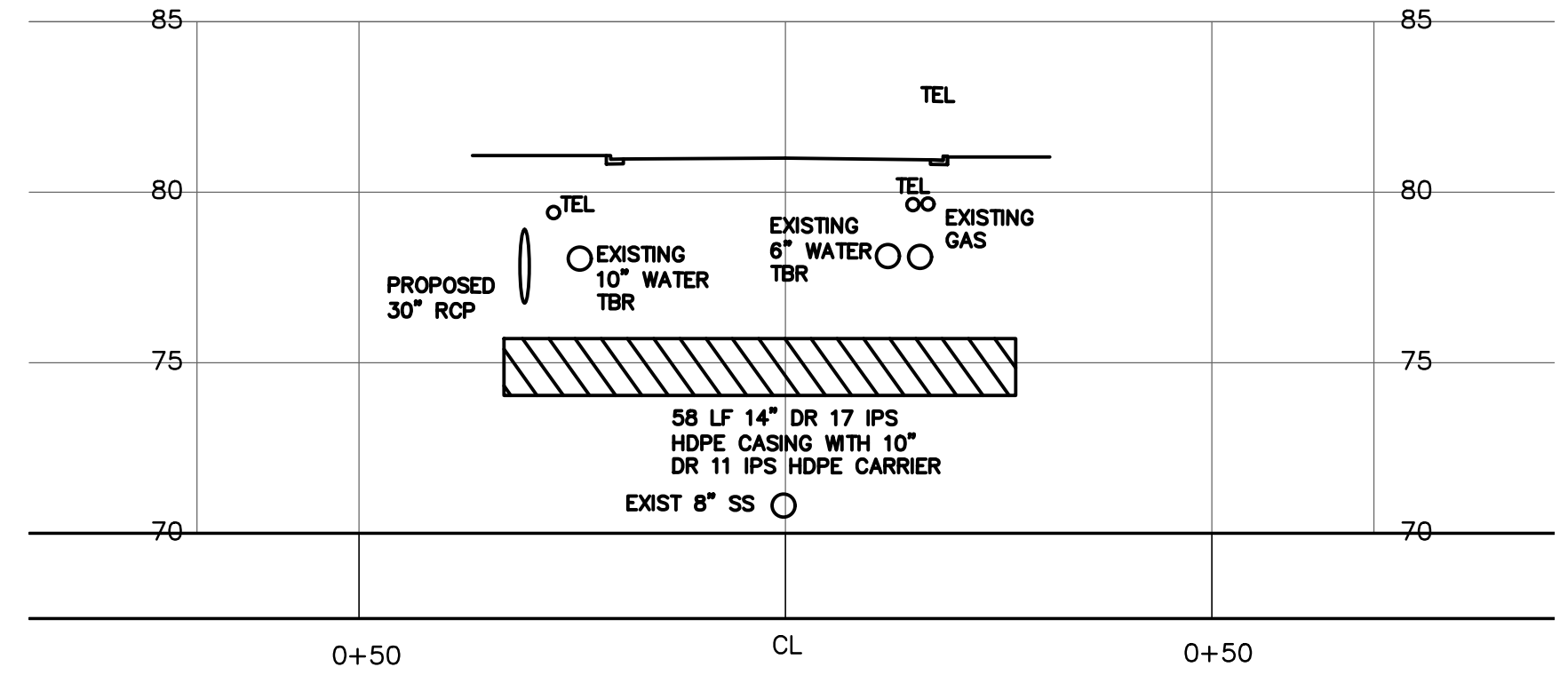

DRAWING COMPLETED BY: _____
 REVISED: _____

GEORGIA REGISTERED PROFESSIONAL ENGINEER
 PAUL C. SIMONTON
 Level II Certification No. 935
 Expiration Date: 10-01-23

1050 PARKSIDE COMMONS
 SUITE 101
 GREENSBORO, GA 30642
 TEL: (706) 454-0870

309 N. MAIN ST.
 P.O. BOX 309
 HINESVILLE, GA 31313
 912-244-7800
 www.simontongenr.com

SIMONTON ENGINEERING

South Main Street Widening
 for
 The City of Hinesville
 Liberty County, Georgia

Utility Plan

DATE: August 17, 2020
 FILE NO: 2010-45PRI
 SHEET: C4.1

MATCHLINE - STA 27+00 - SHEET C4.1

MATCHLINE - STA 33+00 - THIS SHEET

MATCHLINE - STA 33+00 - THIS SHEET

MATCHLINE - STA 39+00 - SHEET C4.3

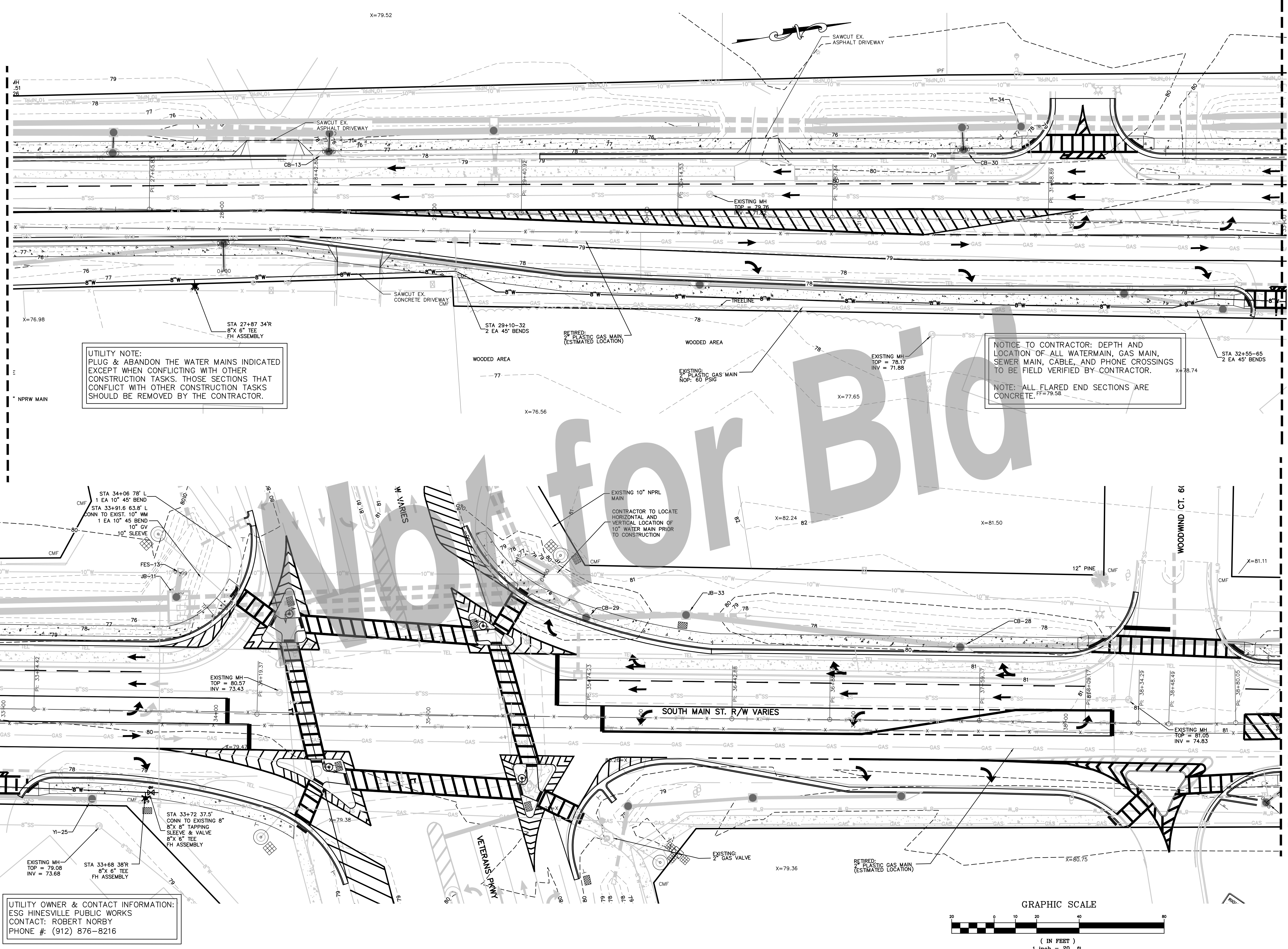

UTILITY NOTE:
 PLUG & ABANDON THE WATER MAINS INDICATED EXCEPT WHEN CONFLICTING WITH OTHER CONSTRUCTION TASKS. THOSE SECTIONS THAT CONFLICT WITH OTHER CONSTRUCTION TASKS SHOULD BE REMOVED BY THE CONTRACTOR.

NOTICE TO CONTRACTOR: DEPTH AND LOCATION OF ALL WATERMAIN, GAS MAIN, SEWER MAIN, CABLE, AND PHONE CROSSINGS TO BE FIELD VERIFIED BY CONTRACTOR.

NOTE: ALL FLARED END SECTIONS ARE CONCRETE.

UTILITY OWNER & CONTACT INFORMATION:
 ESC HINESVILLE PUBLIC WORKS
 CONTACT: ROBERT NORBY
 PHONE #: (912) 876-8216

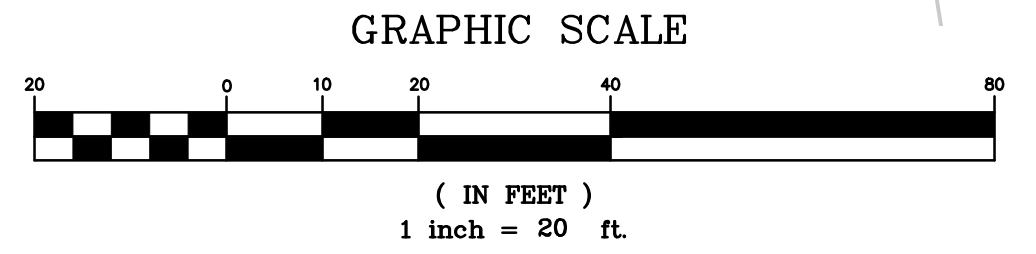

DRAWING COMPLETED BY: _____
 REVISED: _____



Level II Certification No. 935
 Expiration Date: 10-01-23

1050 PARKSIDE COMMONS
 SUITE 101
 GREENSBORO, GA 30642
 TEL: (706) 454-0870

309 N. MAIN ST.
 P.O. BOX 309
 HINESVILLE, GA 31313
 912-244-7800
 www.simontongenr.com

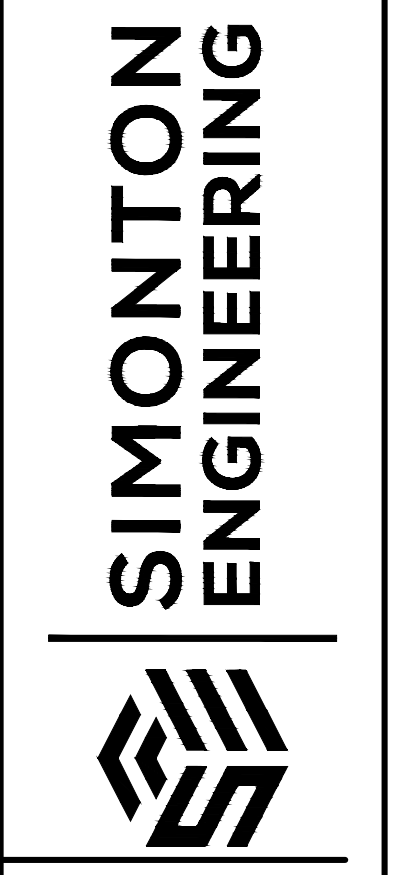

South Main Street Widening
 for
 The City of Hinesville
 Liberty County, Georgia

Utility Plan

DATE: August 17, 2020
 FILE NO: 2010-45PRJ
 SHEET: C4.2

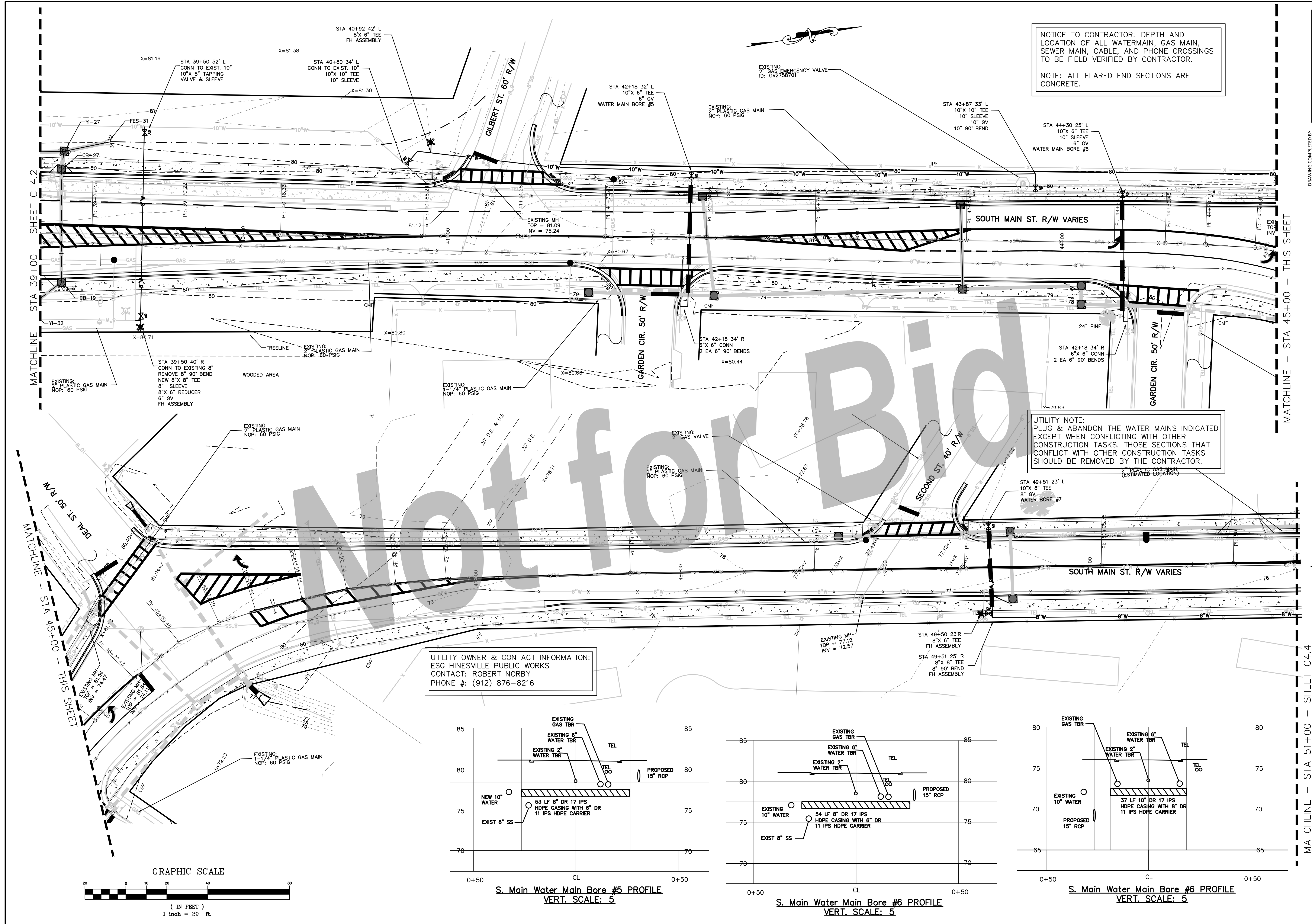

NOTICE TO CONTRACTOR: DEPTH AND LOCATION OF ALL WATERMAIN, GAS MAIN, SEWER MAIN, CABLE, AND PHONE CROSSINGS TO BE FIELD VERIFIED BY CONTRACTOR.

NOTE: ALL FLARED END SECTIONS ARE CONCRETE.

UTILITY NOTE:
 PLUG & ABANDON THE WATER MAINS INDICATED EXCEPT WHEN CONFLICTING WITH OTHER CONSTRUCTION TASKS. THOSE SECTIONS THAT CONFLICT WITH OTHER CONSTRUCTION TASKS SHOULD BE REMOVED BY THE CONTRACTOR.

UTILITY OWNER & CONTACT INFORMATION:
 ESG HINESVILLE PUBLIC WORKS
 CONTACT: ROBERT NORBY
 PHONE # (912) 876-8216

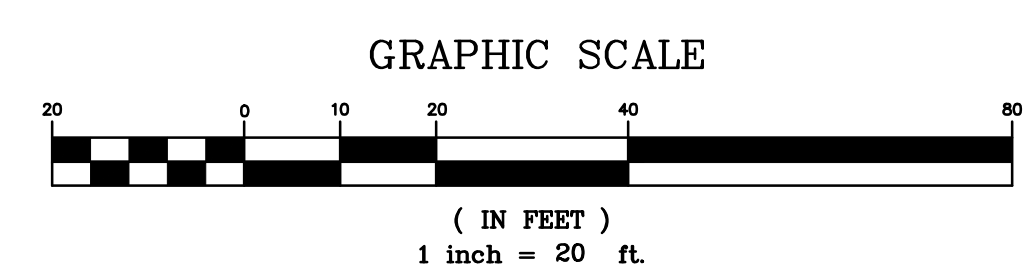
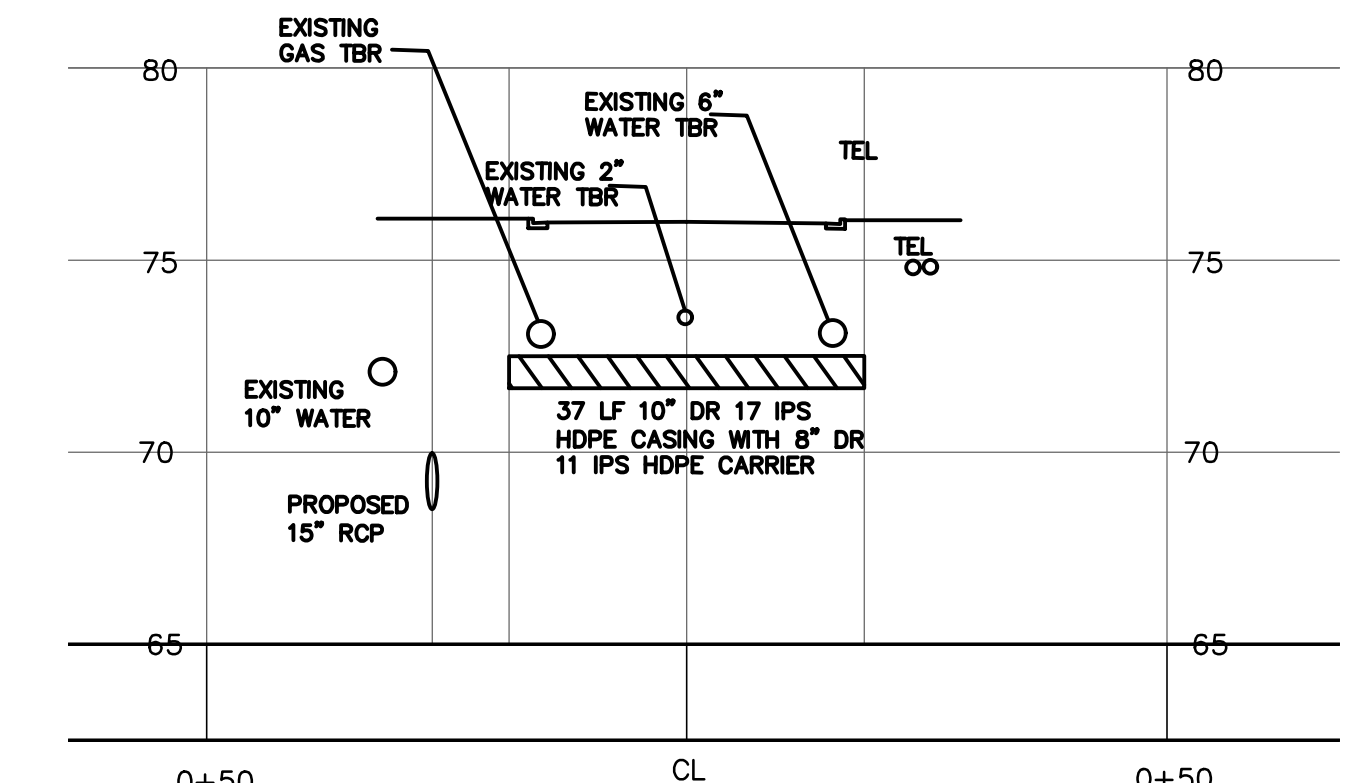
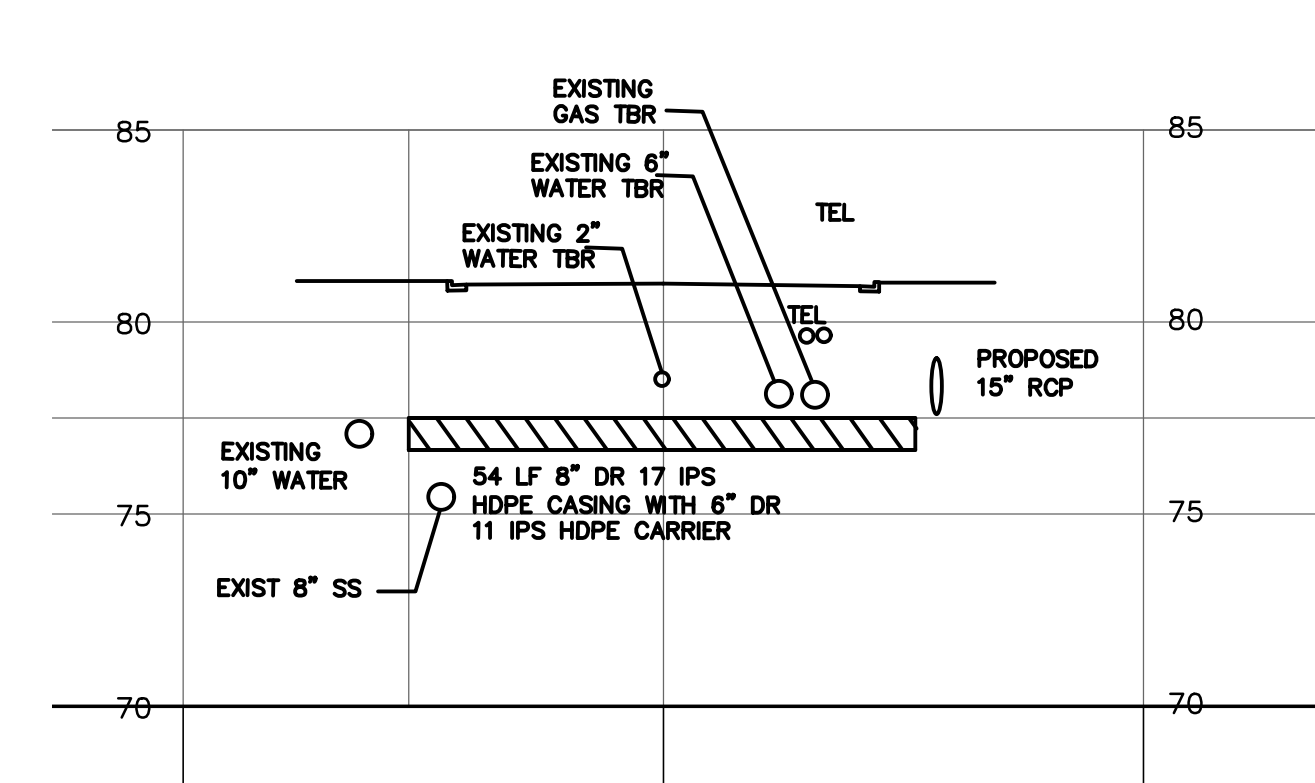
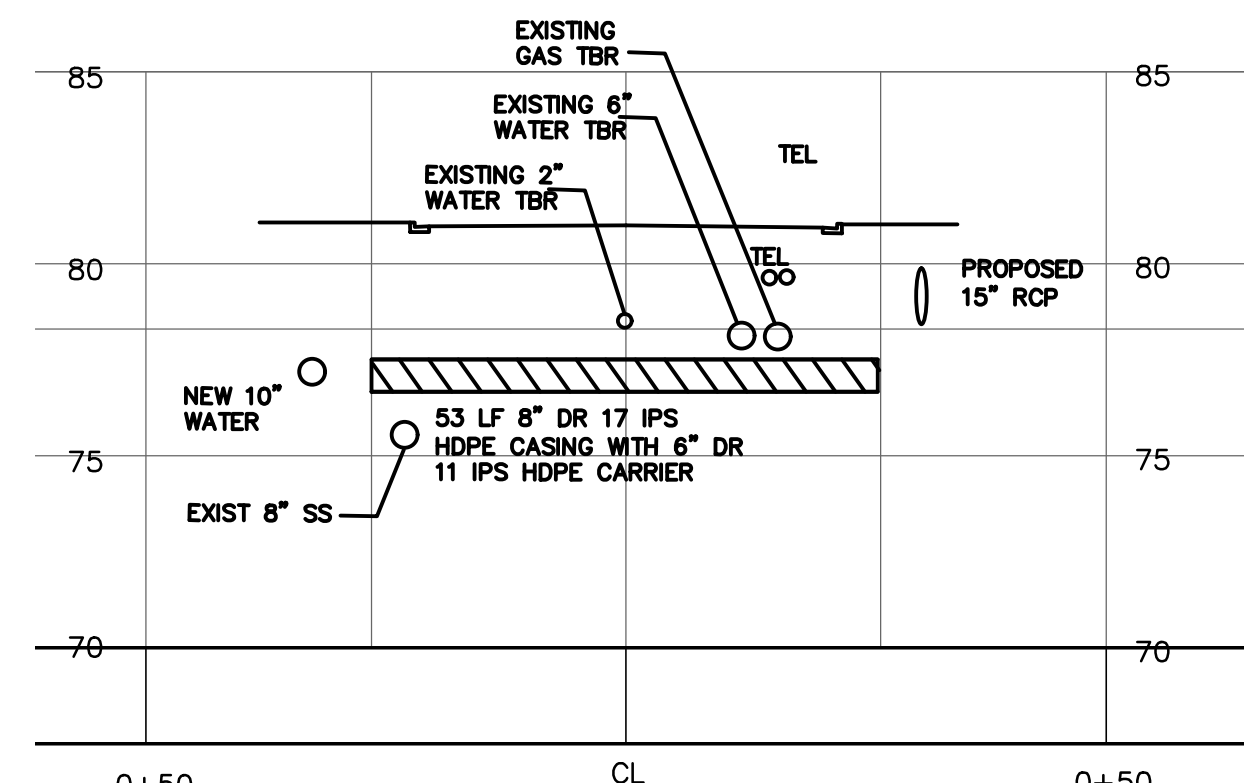

DRAWING COMPLETED BY: _____

REVISED: _____



Level II Certification No. 935
 Expiration Date: 10-01-23

1050 PARKSIDE COMMONS
 SUITE 101
 GREENSBORO, GA 30642
 TEL: (706) 454-0970
 309 N. MAIN ST.
 P.O. BOX 309
 HINESVILLE, GA 31313
 912-244-7800
 www.simontonengineering.com

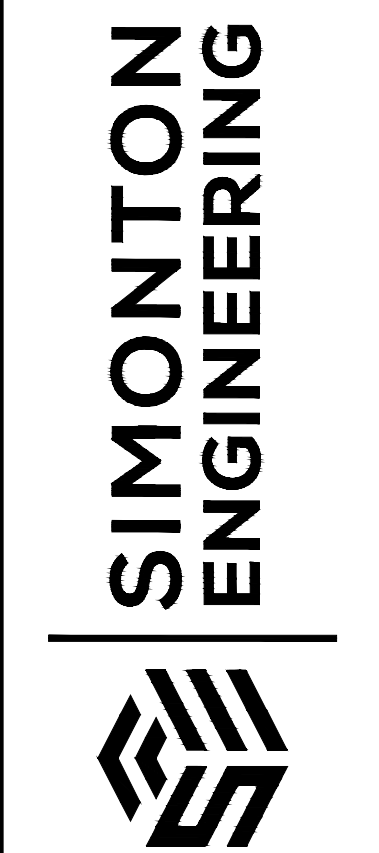

South Main Street Widening
 for
 The City of Hinesville
 Liberty County, Georgia

Utility Plan
 DATE: August 17, 2020
 FILE NO: 2010-45PRJ
 SHEET: C4.3

NOTE: CONTRACTOR SHALL INSTALL A CONSTRUCTION EXIT AT THE CONTRACTOR'S DESIGNATED LAY-DOWN YARD. SEE DETAIL SHEET C8.0. GPS COORDINATES FOR CONSTRUCTION EXIT TO BE DETERMINED.

NOTICE TO CONTRACTOR: DEPTH AND LOCATION OF ALL WATERMAIN, GAS MAIN, SEWER MAIN, CABLE, AND PHONE CROSSINGS TO BE FIELD VERIFIED BY CONTRACTOR.

NOTE: ALL FLARED END SECTIONS ARE CONCRETE.

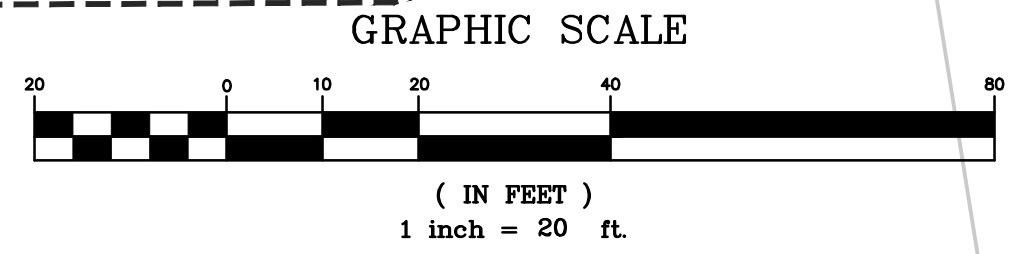
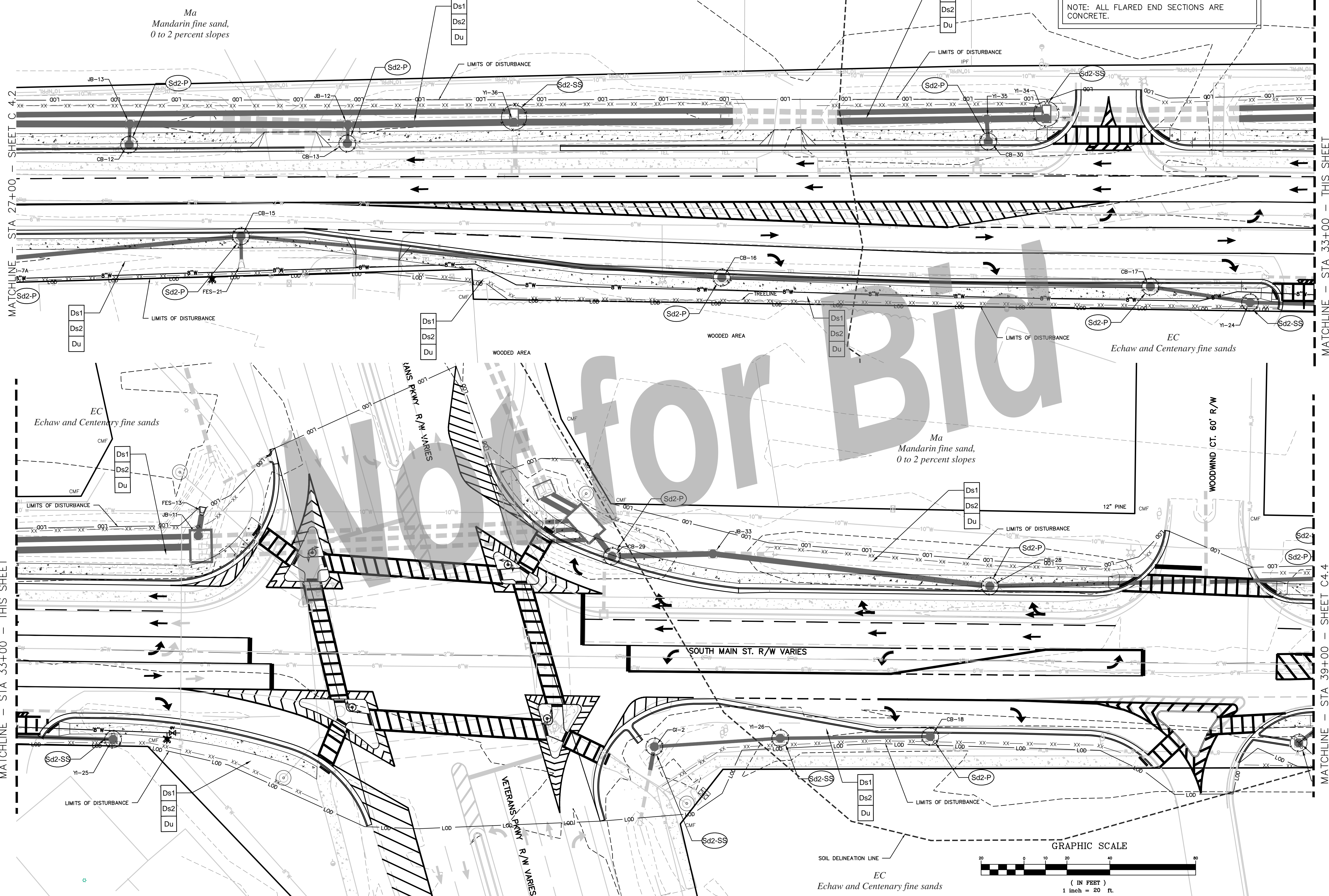

MATCHLINE - STA 27+00 - SHEET C 4.2

MATCHLINE - STA 33+00 - THIS SHEET

MATCHLINE - STA 33+00 - THIS SHEET

MATCHLINE - STA 39+00 - SHEET C4.4

DRAWING COMPLETED BY:

REVISED:

THIS DRAWING IS AN INSTRUMENT OF SERVICE AND REMAINS THE PROPERTY OF SIMONTON ENGINEERING, LLC. IT MAY NOT BE COPIED, ALTERED, OR REPRODUCED IN ANY MANNER WITHOUT THE WRITTEN CONSENT OF SIMONTON ENGINEERING, LLC. THE EVENT OF AN ELECTRONIC VERSION SIMONTON ENGINEERING, LLC. ASSUMING NO LIABILITY FOR ANY ERRORS OR OMISSIONS. HARD COPIES WILL TAKE PRECEDENCE OVER ANY ELECTRONIC MEDIA. SIMONTON ENGINEERING, LLC.

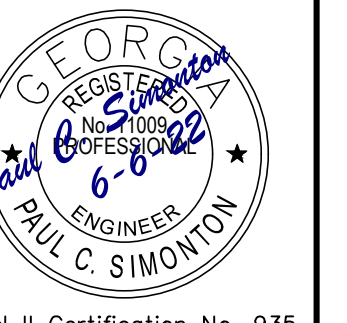

Level II Certification No. 935
Expiration Date: 10-01-23

1050 PARKSIDE COMMONS
SUITE 101
GREENSBORO, GA 30642
TEL: (706) 454-0970
309 N. MAIN ST.
P.O. BOX 509
HINESVILLE, GA 31313
912-244-7600
www.simontonengineering.com

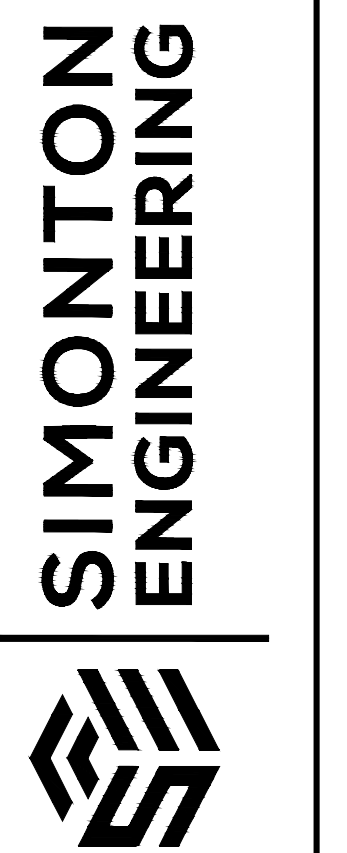

South Main Street Widening
for
The City of Hinesville
Liberty County, Georgia

Erosion, Sedimentation & Pollution Control Plan
DATE: August 17, 2020
FILE NO: 2010-45PRU
SHEET: CG. 4

PHASING DIAGRAM

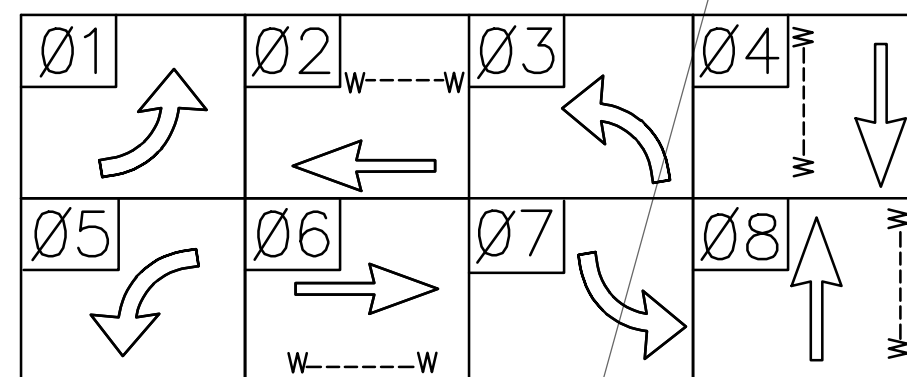

REPLACE EXISTING SIGNAL HEADS
SIGNAL HEADS W/ RETROREFLECTIVE BACK PLATES

LED INCANDESCENT LOOK

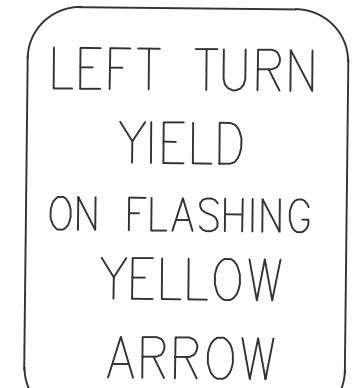
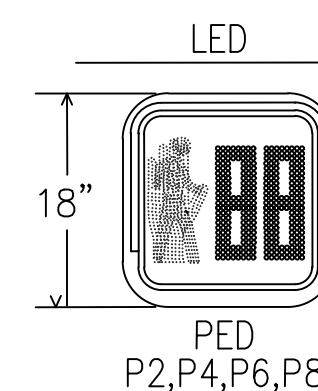
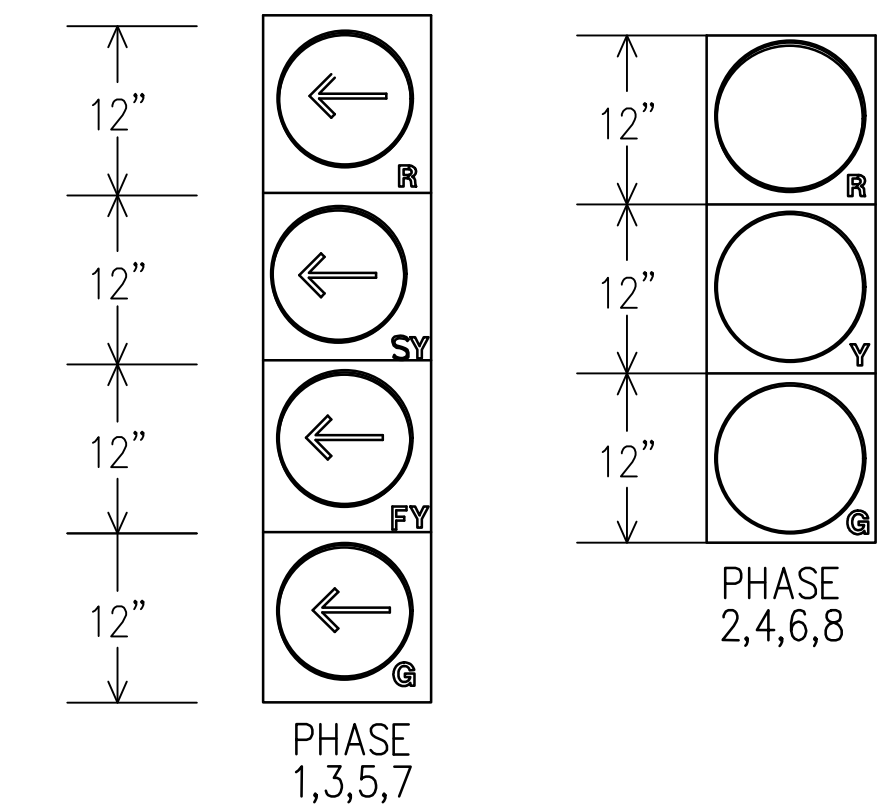

R1-2
36" X 36" X 36"

R10-5A
30" X 36"

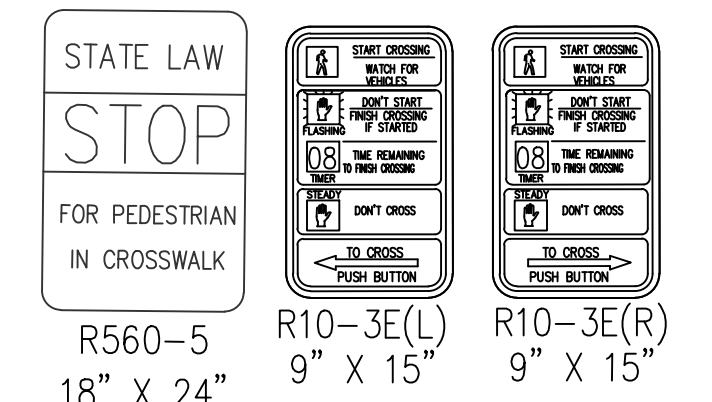

STREET SIGNS

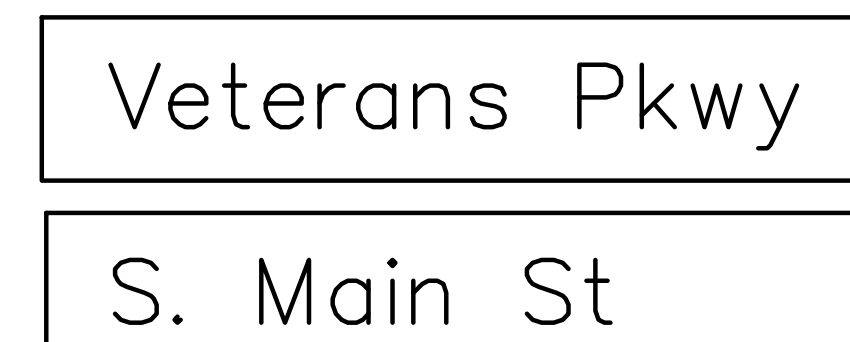

REUSE EXISTING SIGNS

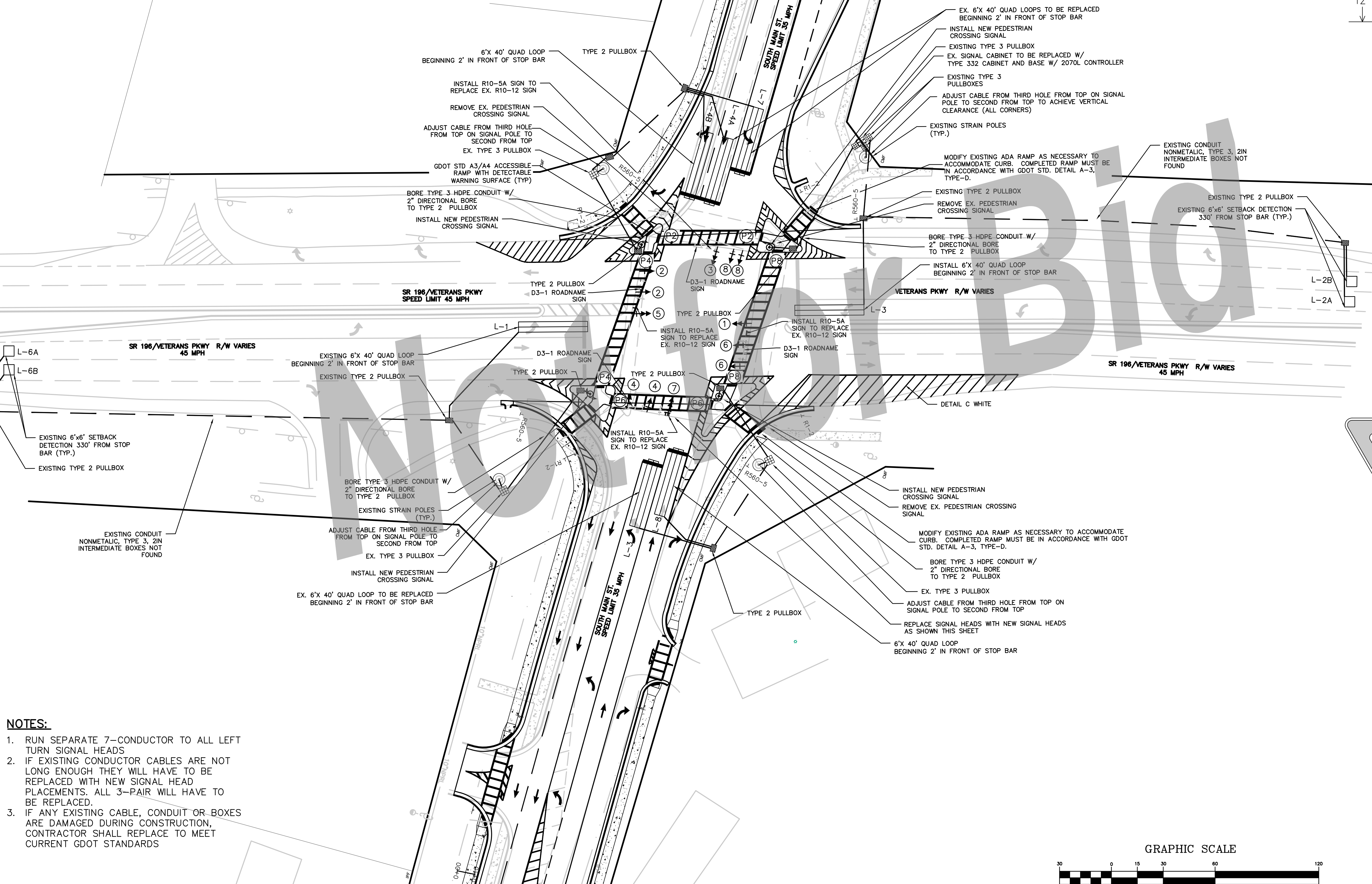
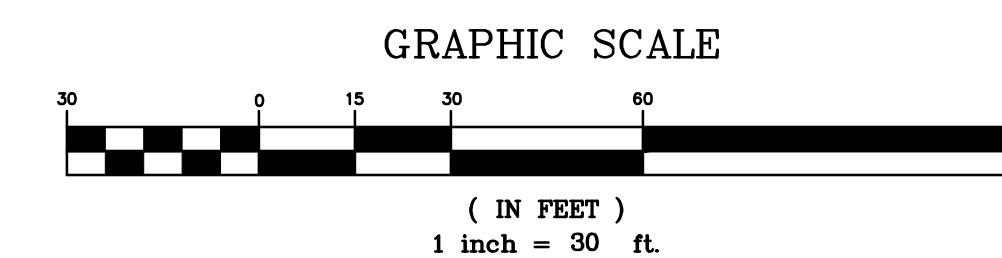

- NOTES:**
1. RUN SEPARATE 7-CONDUCTOR TO ALL LEFT TURN SIGNAL HEADS
 2. IF EXISTING CONDUCTOR CABLES ARE NOT LONG ENOUGH THEY WILL HAVE TO BE REPLACED WITH NEW SIGNAL HEAD PLACEMENTS. ALL 3-PAIR WILL HAVE TO BE REPLACED.
 3. IF ANY EXISTING CABLE, CONDUIT OR BOXES ARE DAMAGED DURING CONSTRUCTION, CONTRACTOR SHALL REPLACE TO MEET CURRENT GDOT STANDARDS

DRAWING COMPLETED BY: _____
 REVISED: 5-25-22 MODIFIED PER GDOT COMMENTS

THIS DRAWING IS AN INSTRUMENT OF SERVICE AND REMAINS THE PROPERTY OF SIMONTON ENGINEERING, LLC. IT MAY NOT BE COPIED, ALTERED, OR REPRODUCED IN ANY MANNER WITHOUT PERMISSION ON A SIGNED AND SEALED DOCUMENT. THE EVENT OF AN ELECTRONIC VERSION SIMONTON ENGINEERING, LLC ASSUMES NO RESPONSIBILITY FOR DATA GENERATED, ALTERED OR STAMPED FROM THIS DRAWING. "ELECTRONIC MEDIA" - SIMONTON ENGINEERING, LLC.

GEORGIA
 REGISTERED PROFESSIONAL ENGINEER
 PAUL C. SIMONTON

Level II Certification No. 935
 Expiration Date: 10-01-23

1050 PARKSIDE COMMONS
 GREENSBORO, GA 30642
 TEL: (706) 454-0870
 309 N. MAIN ST.
 P.O. BOX 309
 HINESVILLE, GA 31313
 912-244-7900
 www.simontongen.com

SIMONTON ENGINEERING

South Main Street Widening
 for
 The City of Hinesville
 Liberty County, Georgia

GDOT Intersection Plan
 DATE: August 17, 2020
 FILE NO: 2010-45PRU
 SHEET: C7.0

List of Materials			
List of Materials is for information purpose only. The Contractor shall field verify all materials and quantities required for installation			
All materials and specifications to meet GDOT Standards & Specifications			
Item	Materials	Unit	Quantity
Controller Cabinet Assembly			
A. Controller Unit, Model 2070LX		EA	1
E. Cabinet Assembly, Model 332		EA	1
F. Switch Pack (Load Switch)		EA	16
G. DC Isolator		EA	3
H. Loop Detector, 2 Channel		EA	9
L. Monitor to be 2018KClip Monitor		EA	1
M. Auxiliary Output File		EA	1
Loop/PED Lead-in wire (Shielded, Twisted/1000 ft)		Reel	4
A. 3 Pair 18 AWG		Reel	4
Signal Cable (14 AWG)		Reel	4
B. 7 Conductor per 1000 ft		Reel	4
Loop Detector Wire (114 AWG, Stranded/1000 ft)		Reel	4
3 Section, 12" Signal Head LED,			
Yellow Housing w/ Black Front Plastic		EA	8
4 Section, 12" Signal Head LED,			
Yellow Housing w/ Black Front, Plastic (Red, Yellow, Yellow Flash and Green Arrow)		EA	4
Plastic Louvered Back Plate for One-Way, 3 Section, 12" Signal Head w/ Retroreflective Strip		EA	8
Plastic Louvered Back Plate for One-Way, 4 Section, 12" Signal Head w/ Retroreflective Strip		EA	4
1- Section 18" LED Countdown Pedestrian Signal head, Full, Handman Overlap 9" High Numbers and 12" Symbols		EA	8
Pedestrian Pushbutton Stations, w/ Type A Buttons and signs 9"x 15", R10-3E (L:left or R:right, Countdown			
1. 9"x 15" R-10-3L, Countdown		EA	4
2. 9"x 15" R-10-3R, Countdown		EA	4
Hardware for Mast Arm Mounting		EA	12
Hardware for Pedestal Pole, Top Post Mounting			
Two-way Bracket Assembly		EA	4
Pedestal Pole and Square Base		EA	4
Pull Box, PB-2		EA	10
Pull Box, PB-3		EA	4
Loop Saw Cut		LF	1300
Conduit, 1"		LF	100
Conduit, 2"		LF	290
Conduit Type 3 2 in		LF	100
R560-S Sign w/ Post		EA	4
R10-5-N Left Turn Yield on Flashing Yellow Sign		EA	4
Misc Matl to Complete Installation		LUMP	1

332 CABINET INPUT ASSIGNMENT

		UPPER INPUT FILE													
		1	2	3	4	5	6	7	8	9	10	11	12	13	14
TYPE		DET	DET	DET	DET	DET	DET	DET	DET	DET	TBA	TBA	DC	DC	DC
CARD		2-CH	2-CH			2-CH	2-CH						DC ISO	DC ISO	DC ISO
CHANNEL 1	C1 PIN	56	39	63	47	58	41	65	49	50			80	67	81
	FUNCTION	MS	REA			7	4A						ADV	2 PED	86 PED
	FIELD TERM	TBE 1,2	TBE 5,6	TBE 9,10	TBA 1,2	TBA 5,6	TBA 9,10	TBE 1,2	TBE 5,6	TBE 9,10				TBA 4,6	TBA 7,9
ACTRA/SEFAC	DETECTOR	1	3	5	7	9	11	13	15	17				PED 2	PED 6
ACTRA/SEFAC	ASSIGNED	1	2	2	2	3	4	4	4	1				82	86
		LOWER INPUT FILE													
TYPE		DET	DET	DET	DET	DET	DET	DET	DET	DET	TBA	TBA	DC	DC	DC
CARD		2-CH	2-CH			2-CH	2-CH								
CHANNEL 1	C1 PIN	55	40	64	48	57	42	66	50	59			54	71	51
	FUNCTION	1	86A			3	8								
	FIELD TERM	TBS 1,2	TBS 5,6	TBS 9,10	TBS 1,2	TBS 5,6	TBS 9,10	TBI 1,2	TBI 5,6	TBI 9,10				TBS 4,6	TBS 7,9
ACTRA/SEFAC	DETECTOR	19	21	23	25	29	31	33	35	37				PRE 3	PRE 4
ACTRA/SEFAC	ASSIGNED	5	6	6	6	7	8	8	8	5					
		LOWER INPUT FILE													
TYPE		DET	DET	DET	DET	DET	DET	DET	DET	DET	TBA	TBA	DC	DC	DC
CARD		2-CH	2-CH			2-CH	2-CH								
CHANNEL 2	C1 PIN	55	44	77	48	57	46	79	50	61			75	73	52
	FUNCTION		86B												
	FIELD TERM	TBS 3,4	TBS 7,8	TBS 11,12	TBS 3,4	TBS 7,8	TBS 11,12	TBI 3,4	TBI 7,8	TBI 11,12				TBS 5,6	TBS 8,9
ACTRA/SEFAC	DETECTOR	19	22	24	25	29	32	34	35	38				PRE 5	PRE 6
ACTRA/SEFAC	ASSIGNED	5	6	6	6	7	8	8	8	7					PRE 2

